

## 不锈钢抓绳器使用说明书

### ROPE GRAB

## Safety precautions

This manual explains how to use the equipment and only appropriate techniques and uses are described. Warning signs tell the potential risks but they don't cover everything. Please read every each warning carefully and use your equipment properly. Any misuse might lead to danger. If you are in doubt, please contact XINDA.



Risk of severe injury or death



Risk of accident or harm

**OK!**

Appropriate way of use



Incorrect way of use

## Applicable rope diameter

$16 \leq \varnothing \leq 19\text{mm}$

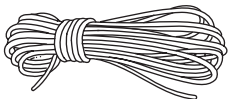

## Product Showcase

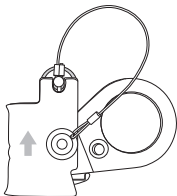

(Front)

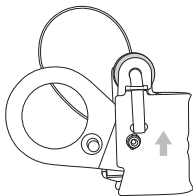

(Back)

## Component Names

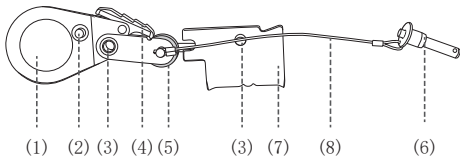

(1) Connection hole

(4) Latching teeth

(7) Housing

(2) Locking bar

(5) Roller

(8) Pin lanyard

(3) Socket

(6) Pin shaft

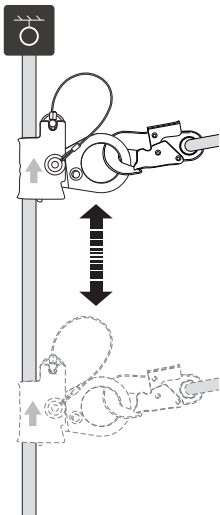

(a)

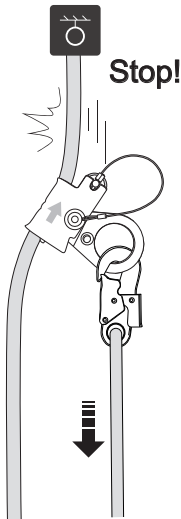

(b)

ISO9001 Standards Complied



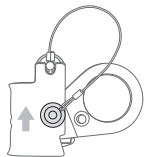

(1)

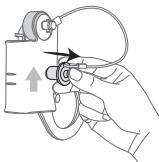

(2)

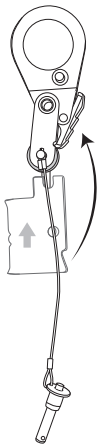

(3)

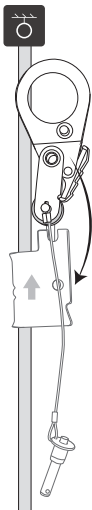

(4)

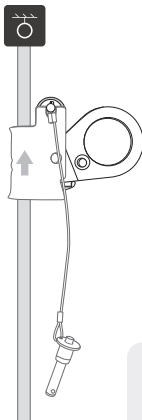

(5)

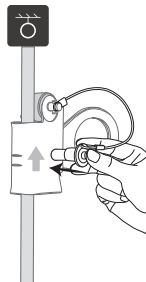

(6)

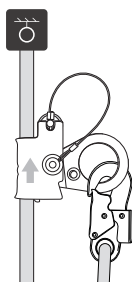

(7)

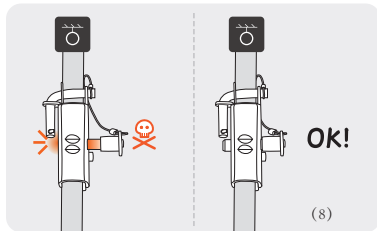

(8)

## Precautions for Use

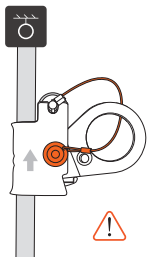
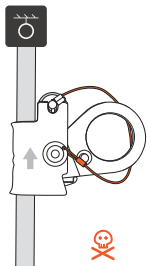
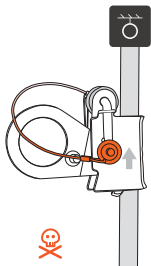

### SCOPE OF APPLICATION

Designed for rope access work, this is personal protective equipment intended to prevent falls.

- Operating temperature range: -20°C to 50°C
- Maximum working load: 100 kg
- Compatible with ropes with a diameter of 16–19 mm.

### DISCLAIMER

#### WARNING

Any activity involving the use of this equipment carries inherent risks.

You are responsible for your own actions, decisions, and safety.

Before using this equipment, you must:

- Read and understand the entire user manual;
- Undergo specific training for the use of this equipment;
- Familiarize yourself with your equipment, understand its performance, and be aware of its limitations;
- Understand and accept the risks involved.

Failure to heed any of the above warnings may result in serious injury or death.

This product must only be used by competent and responsible individuals, or under the direct visual supervision of competent and responsible individuals.

You are responsible for your own actions, decisions, and safety, and must accept the consequences. If you are unable to assume this responsibility or fully understand these instructions, do not use this equipment.

## PRE- AND POST-USE INSPECTIONS

**Be sure to ensure that:**

- **The equipment is suitable for its intended use;**
- **Ropes (slings): No damaged stitching, no hardening, no variations in thickness, and no cuts,** No wear or fraying.

Check for cuts and loose threads!

- Metal parts: No deformation, cracks, or wear.

Pay special attention to:

- Ensure there is no mud, sand, or lubricant at the points where the rope passes through;
- Ensure the main lock functions properly and opens and closes smoothly.

## ADDITIONAL SAFETY INFORMATION

· Users must be physically fit for work at heights. Unintended suspension at height can result in serious injury or even death within a short period of time.

· In industrial work environments, when a fall arrest device is used in a personal rope access system, it must be operated in conjunction with a fall arrest system.

Sufficient clearance must be maintained below the fall arrest system during work to prevent collision with obstacles or the ground during a fall arrest.

· In industrial work environments, the minimum breaking load of a single anchor point must be at least 12 kN, or the anchor point must comply with the EN 795 standard.

· In a safety system, the system's strength is determined by the weakest link in the entire system.

· Take care to prevent ropes or other webbing equipment from rubbing against sharp edges or rough surfaces.

Conduct a risk assessment of the work environment before

work begins and implement appropriate safety measures.

- Do not work alone. Prepare an emergency response plan before work begins to ensure rapid rescue in the event of an accident.

## **INSTALLATION INSTRUCTIONS**

Follow the instructions in the diagram, paying close attention to the installation orientation of the rope clamp.

First, press the pin downward to unlock it and pull out the pin shaft. Open the rope clamp, insert a rope with a diameter of 16–19 mm, close the rope clamp, reinsert the pin shaft to lock it in place, and then attach the carabiner to the connection hole.

Note: The pin shaft must be fully inserted through the main body of the housing; failure to do so may result in serious injury or death. (See Figure 8)

## **FUNCTIONAL PRINCIPLES AND TESTING**

When no force is applied, the rope clamp can slide up and down along the rope. When force is applied to the connection hole, the teeth will squeeze the rope against the inner side of the body, locking it in place.

Warning: Pulling on the body of the device will release the lock. Any pressure applied to the cam will release the lock. Do not hold the rope clamp with your hands.

## **SERVICE LIFE, PERIODIC INSPECTIONS, AND EQUIPMENT RETIREMENT**

- Metal equipment stored under proper conditions has no storage time limit. However, if the metal product contains plastic components, the storage life of those plastic

components is 10 years.

- The product may be damaged during its first use due to improper operation, accidents, or compatibility issues between components.

- The actual service life of the product depends on the environment in which the equipment is used, the frequency of use, and the severity of environmental conditions (e.g., marine environments, extreme temperatures, sandy environments, etc.). Determining whether a product has reached the end of its service life requires regular inspections. In addition to inspections before, during, and after each use, a comprehensive inspection must be conducted at least once every 12 months. If the equipment is used frequently, the inspection frequency should be increased.

- Inspections must be performed by personnel authorized by the manufacturer who are qualified to inspect PPE.

- A comprehensive inspection of the rope grab includes:

- Checking the metal and plastic components of the rope grab for corrosion, melting, cracks, excessive wear, deformation, or contamination;

- Checking all connection points of the rope grab for excessive wear (wear must not exceed 0.5 mm);

- Checking that all rotating shafts rotate freely.

- Check whether the teeth on the rope gripper cam are severely worn;

- Check whether the rope gripper is functioning properly;

- When the markings on the rope gripper are worn and illegible;

If any of the above checks reveal issues—such as deformation or the shaft failing to rotate freely—the

equipment must undergo appropriate maintenance, be scrapped, or be sent to the manufacturer for further inspection.

**You should dispose of your product when any of the following situations occur:**

- The equipment's usage history is unknown;
- If you have concerns about the product's performance, strength, or safety;
- If it fails a PPE inspection;
- If the product is malfunctioning;
- If the product no longer complies with updated regulations or standards;
- If the product has been subjected to a high-load impact or a severe fall.

How to dispose of your equipment:

Mark the product with a permanent label or physically destroy it to render it unusable (e.g., by drilling holes or cutting it); or return it to the manufacturer for disposal.

## **RESPONSIBILITY**

- You are responsible for your own actions and decisions. If you cannot accept responsibility for the consequences, do not use this product.
- This product may only be used by qualified personnel or under the direct visual supervision of qualified personnel who can assume responsibility.
- Training is required before using this product. Training must include both theoretical and practical components. Users must understand the principles of working at heights, how to use the equipment, and relevant knowledge of safety systems, and may only use the

product independently after completing practical training.

- When the product is resold to other countries or regions, an instruction manual in the language used in that country must be provided.

- Unless due to quality issues, Xinda assumes no liability for any direct or indirect consequences resulting from the use of this product.

Warning: Any unauthorized modification, replacement of parts, or repair of the product is strictly prohibited.

### **3-YEAR WARRANTY**

We offer a 3-year warranty for defects in materials or workmanship. The warranty does not cover: wear and tear, deformation, oxidation, damage resulting from unauthorized modifications or repairs, improper operation, improper maintenance or storage, or damage caused by using the product for purposes other than those for which it was designed.