



If you have any doubts or difficulties
in understanding this manual, please contact
Zhejiang Bingfeng Outdoor Product Co., Ltd.

Phone number: +86 400-8856993
No.19 Xinchao Road, Wangjiang Community, Baiyun Street,
Dongyang City, Jinhua City, Zhejiang Province, China

Ver.20260424



MANUALLY OPERATED DESCENDER Manual



WARNING:

-Activities involving the use of this equipment are inherently dangerous and can lead to severe injury or even death. You must be responsible for your actions and decisions.

-Read and understand the instructions before use.

-Before using this product, it is essential to have got adequate training, understood and mastered the basics and techniques.

-This product must not be used beyond its limits, nor be used for any purpose other than for which it is designed.



Marking

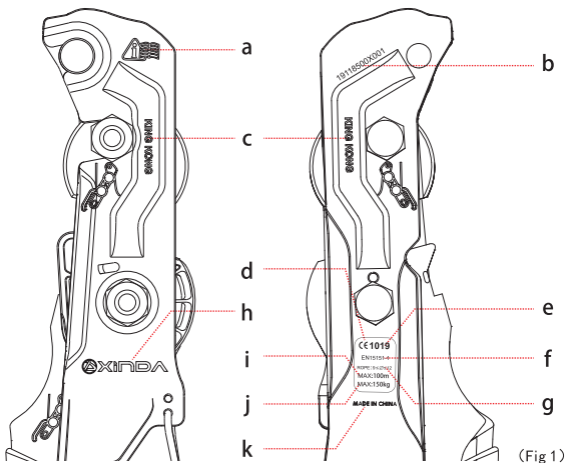

(Fig 1)

- a. Logo to remind the user to read the instructions
- b. Tracking code
- c. Product name
- d. CE certification marking
- e. Body controlling the manufacture of this product

- f. Used standards
- g. Diameter of the compatible rope
- h. The name of the manufacturer or the brand
- i. Maximum descent length
- j. Maximum load
- k. Origin

Nomenclature

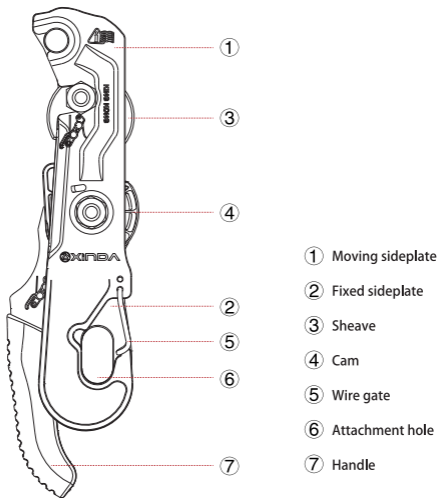

(Fig 2)

Installation and use

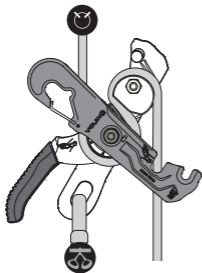

(Fig 3)



(Fig 4)

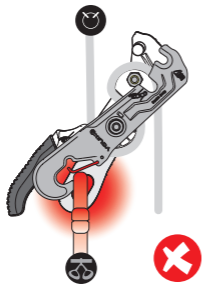

(Fig 5)

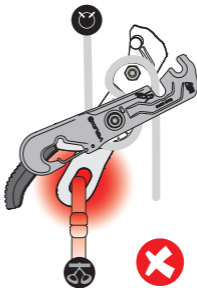

(Fig 6)



Installation and use

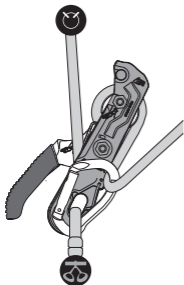

(Fig 7)

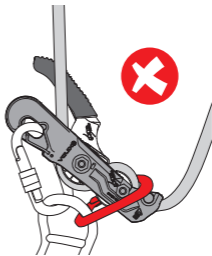

(Fig 8)

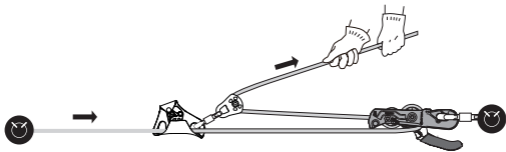

(Fig.11)

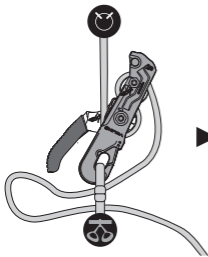

(Fig 9)

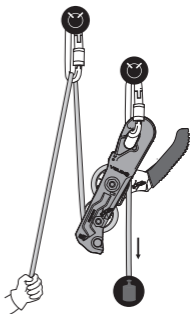

(Fig.10)



This manual explains how to use the equipment and only appropriate techniques and uses are described. Warning signs tell the potential risks but they don't cover everything.

Please read every each warning carefully and use your equipment properly. Any misuse might lead to danger. If you are in doubt, please contact Xinda.

Product details and application

1. Field of application:

This descender with self-braking function is used as PPE (personal protective equipment) which is designed for climbing, caving, canyoning and industrial work.

Main material: aluminum and steel.

Maximum load: 150kg.

2. Installation of the rope:

Open the sideplate and insert the rope according to fig3 and 4. Check the anchor direction and close the sideplate. The moving sideplate can be opened when the carabiner is connected to the fixed sideplate and safety harness, which prevents the descender from falling off the harness.

Note: Please use carablners with locking system.

Function test should be carried out after installation as to make sure the device is installed to the needed direction.

Descent: Press the handle with one hand while holding the braking side of the rope with the other hand. You can control the descent by varying your grip with your hands. Gloves are suggested to use in order to protect your hands from being hurt by the rope.

Auxiliary friction can be added when the descender is used with small diameter ropes or heavy weights(see fig7).

Note: The descender can not be caught by the additional carabiner (see fig8).

Warning: High speed descent may lead to fall, injury or even death.

Braking: This descender has a self-braking function and therefore can stop with hands free. The descender can not work well with ropes that are too thin,

icy or wet. Braking knot is needed for work positioning in case the descender slips downward or gets disabled by the accidental pressure. (see fig9)

Note: The excessive wear of the cam and sheave will reduce the braking effectiveness

Other uses:

Pay attention to the direction of the braking rope and add auxiliary friction when descending(see fig10).

The descender can be used to tension the tyrolean. Excessive load or fall may damage the descender or rope(see fig11).

3.Safety check

Before each use: Check if the product, including attachment holes, sideplates, cam and sheave, is free of cracks, deformation, corrosion and excessive wear etc. Verify that the sideplate and axle work well.

During each use: Check if the sideplate can be opened and closed normally and the carabiner is loaded from the main axle. Verify that the rope is pulled straight. Make sure that no foreign object comes into contact with the device.

4. Additional safety information:

- The user's health and body condition must be fit for working at heights. Unconscious suspension at height can lead to severe injury or even death. Ensure that a rescue procedure is in place.
- In a rope access system, it is essential to use a back up device and check the required clearance below the user in order to avoid any impact with the ground or with an obstacle in case of a fall.
- In the industrial use, the breaking load of a single anchor point must be 12kN at least or meet the standards of EN 795.
- In a safety system, the weakest component determines the strength of the whole system.
- Avoid that the rope and other braided fabric rub against sharp edges or rough surfaces.
- A risk assessment is needed and protection measures should be taken before use.

- Working alone is not allowed and you should have a rescue plan and the means to implement it in case of encountered difficulties.

5.Life span, regular inspection and retirement:

- No storage limit for the metal in the proper environment; the plastic parts of the equipment can be stored up to 10 years.
- The equipment may need to be retired only after one use because of misuse, accidents or compatibility problems.

● The practical lifespan depends on the type and intensity of usage, harsh environment(marine environment, extreme temperatures, sand and mud etc). Equipment check has great effect on the lifespan.

The comprehensive inspection is required once every 12 months minimum, apart from normal check before use, during use and after use. The greater the intensity of use, the more checks are needed. Record the results of the inspection.

- The inspector must be competent or authorized by the manufacturer.
- Inspections included:

- Check if the products are free of corrosion, melting, cracks, wear, deformation or stain;
- Check if the attachment points are overworn(0.5mm at most);
- Check the effectiveness of the springs and pivots;
- Check if the cam teeth are worn greatly;
- Check the functionality of the ascender;
- Check if the markings are illegible;

You should maintain or retire the equipment, or hand to the manufacturer for further inspection when the results are negative such as deformation, malfunction of the pivots.

- Information included on the inspection manual

Model number/data matrix/purchase date/manufacture date/first time to use/standards/inspection date/records(malfunction, condition, user's usage record)

/results and suggestions(to retire the equipment or not)/next inspection date/
inspector's data(name and contact)

● When to retire your equipment:

- You don't know its usage history;
- You doubt about its performance, strength or safety;
- It fails to pass PPE inspection;
- Malfunctions are found;
- It fails to meet updated regulations or standards;
- It has been subjected to a major fall or load;

How to retire your equipment:

Mark it with irremovable labels or destroy it as to prevent further use. For instance, drill or cut it. Or return it to the manufacturer for disposal.

6.Responsibilities:

- You are responsible for your actions and decisions. If you can not take the responsibilities, don't use it.
- Only qualified person or the person under supervision of a competent and experienced party can use this product.
- You must take training course including theory and practice, basics for working at height, proper ways to use and relevant safety system knowledge before use.
- When it is resold to other countries or regions, the instruction manual must be made in local languages.
- XINDA is not responsible for any direct or indirect non-quality induced consequences.

7.Storage and transport:

Remaining fluid and other stain on metal equipment must be rinsed and dried and then stored in a dry environment, 10°C-30°C. The equipment must not come

come into contact with abrasion, loading, chemicals, sharp edges or heat source etc. as those are inherently harmful. Metal equipment must be specially stored in the container and transported in compliance with storage requirements. The use and storage of the product is suggested to be taken care of by accountable people.

8.Maintenance:

Proper maintenance and storage can extend the lifespan of the equipment and also guarantee the user's safety.

-Cleaning: Use clean water(20°C) and soft brush to rinse the external and internal of the product. No high-pressure water. No industrial-grade cleansers. Rinse afterwards and dry it naturally. No heat drying.

-Long time use of the equipment will reduce the lubrication of the parts such pivots. Lubricating oil or grease is suggested to be in use.

Warning: No modification, alternation or improper maintenance is allowed. It can only be repaired in the XINDA factory.

9.Traceability:

The code is used for product tracing.

Meaning: For instance, 18096500J47: 18 096: Manufactured on the 96th day of 2018; 500J: Batch and quality inspection; 47: Product increment.

10.Limited warranty:

XINDA provides a 3-year warranty against any material or manufacturing defects.

Exclusions: normal wear and tear, deformation, oxidation, modifications or alterations, misuses, incorrect storage, poor maintenance, uses for which this product is not designed.