



If you have any doubts or difficulties in understanding this manual, please contact XINDA.

400-8856993

No.19 Xinchao Road, Wangjiang Community, Baiyun Street,
Dongyang City, Jinhua City, Zhejiang Province, China

Ver.20260427

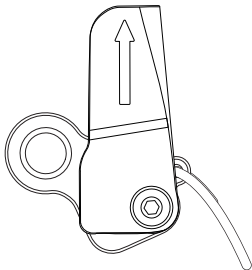

止坠器使用说明书

FALL ARRESTER

Safety precautions

This manual explains how to use the equipment and only appropriate techniques and uses are described. Warning signs tell the potential risks but they don't cover everything. Please read every each warning carefully and use your equipment properly. Any misuse might lead to danger. If you are in doubt, please contact XINDA.



Risk of severe injury or death



Risk of accident or harm

OK!

Appropriate way of use



Incorrect way of use

Applicable rope diameter

#16

$14 \leq \varnothing \leq 16\text{mm}$

#12

$10.5 \leq \varnothing \leq 12\text{mm}$

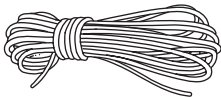

ISO9001 Standards Complied



Thread the rope

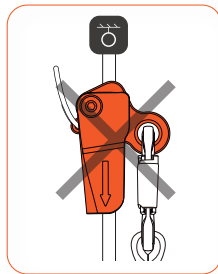
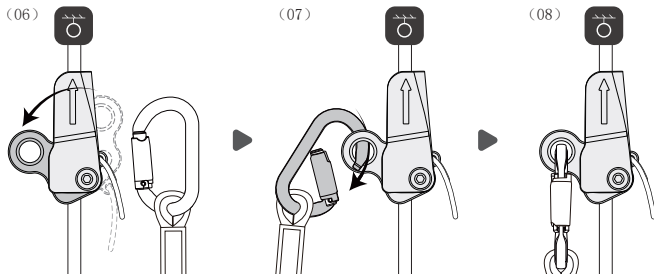
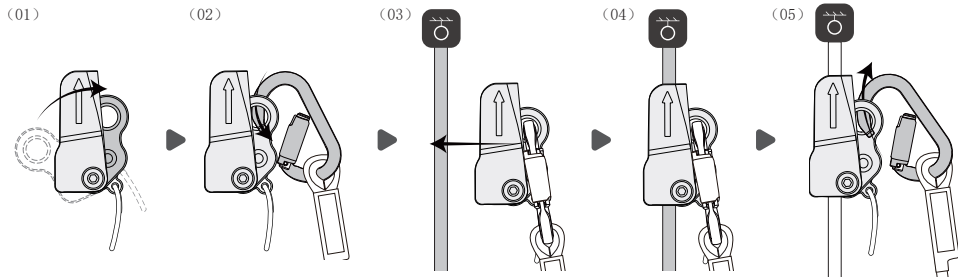

Component Names

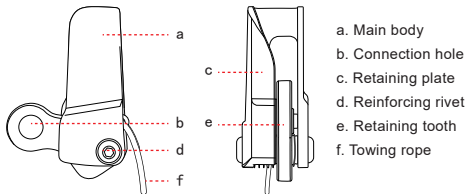

Marking

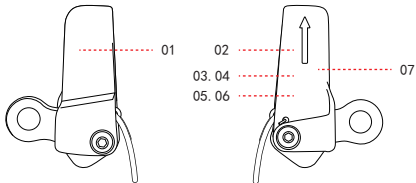

01. Manufacturer's name or brand name
02. Intended use
03. Product part number
04. Applicable standards

05. Applicable rope diameter
06. Working load
07. Reminder to users to read the instructions before use

Functional Testing

a. Ascending

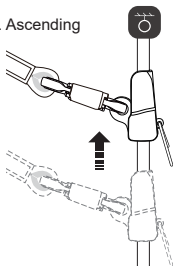

b. Fall arrest

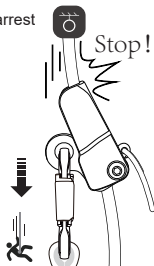

Decrease

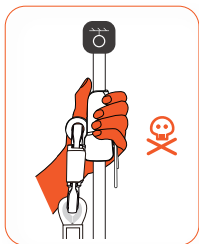
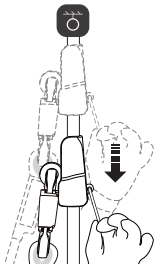

Unhook

(09)



(10)

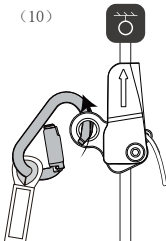

(11)

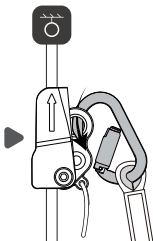

(12)

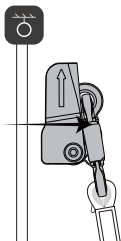

(13)

Important Notes

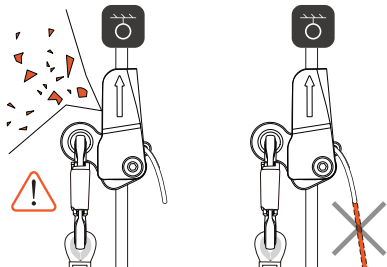

Application Notes

SCOPE OF APPLICATION

Designed for climbing, caving, river trekking, rope access work, and rescue operations, this product is classified as personal protective equipment (PPE) for fall arrest.

- Operating temperature range: -20°C to 50°C
- Maximum working load: The fall arrester device is rated for a maximum working load of 100 kg

DISCLAIMER WARNING

Any activity involving the use of this equipment carries inherent risks. You are responsible for your own actions, decisions, and safety. Before using this equipment, you must:

- Read and understand the entire user manual;
- Undergo specific training for the use of this equipment;
- Familiarize yourself with your equipment, understand its performance, and be aware of its limitations;
- Understand and accept the risks involved.

Failure to heed any of the above warnings may result in serious injury or death.

This product must only be used by competent and responsible individuals, or under the direct visual supervision of competent and responsible individuals.

You are responsible for your own actions, decisions, and safety, and must accept the consequences. If you are unable to assume this responsibility or fully understand these instructions, do not use this equipment.

INSTALLATION INSTRUCTIONS

Follow the instructions in the diagram, paying attention to the orientation of the ropes and equipment.

FUNCTIONAL PRINCIPLES AND TESTING

The rope clamp slides along the rope in one direction and locks in the other. When the connecting hole is pulled, the cam rotates and squeezes the rope against the inside of the body. The cam must always rotate freely.

Warning: Pulling on the body of the device will cause the lock to fail. Any pressure applied to the cam will cause the lock to fail. **Do not hold the rope clamp with your hands.**

PRE- AND POST-USE INSPECTIONS

Be sure to ensure:

- The equipment is suitable for its intended use;
- Ropes (static ropes and slings): No damaged stitching, no hardening, no variations in thickness, no cuts, no wear, and no fraying.

Watch for cuts and loose threads!

- Metal parts: no deformation, cracks, or wear;

Pay special attention to:

- Points where the rope passes through: ensure they are free of mud, sand, and other debris, and that no lubricants are present;
- Ensure the main carabiner functions properly and opens and closes smoothly.

ADDITIONAL SAFETY INFORMATION

·Users must be physically fit for work at heights. Unintentional suspension at heights can result in serious injury or even death within a short period of time.

·In industrial work environments, when a fall arrest device is used in a personal rope access system, it must be operated in conjunction with a fall arrest system. During operations, sufficient clearance must be maintained below the fall arrest system to prevent collisions with obstacles or the ground in the event of a fall arrest.

·In industrial settings, the minimum breaking load for a single anchor point must be at least 12 kN, or the anchor point must comply with the EN 795 standard.

·In a security system, the strength of the system is determined by its weakest link.

·Take care to prevent ropes or other webbing equipment from coming into contact with sharp edges or rough surfaces. Conduct a risk assessment of the work environment before starting work, and implement appropriate safety measures.

·Do not work alone. Before starting work, you must prepare an emergency response plan to ensure a swift rescue in the event of an accident.

SERVICE LIFE, PERIODIC INSPECTIONS, AND EQUIPMENT RETIREMENT

-Metal equipment stored under proper conditions has no storage time limit. However, if the metal product contains plastic components, the storage life of those plastic components is 10 years.

-Due to improper operation, accidents, or compatibility issues between components, the product may be damaged as early as the first use.

-The actual service life of the product depends on the operating environment, frequency of use, and the severity of environmental conditions (such as marine environments, extreme temperatures, and sandy or muddy conditions). Whether the product reaches the end of its service life depends on regular inspections. In addition to inspecting the equipment before, during, and after each use, a comprehensive inspection should be conducted at least once every 12 months. If the equipment is used very frequently, the inspection frequency should be increased.

-Inspections must be conducted by personnel authorized by the manufacturer who are qualified to inspect PPE.

-A comprehensive inspection of the rope grab includes:

- Check the metal and plastic components of the rope grab for signs of corrosion, melting, cracking, excessive wear, deformation, or contamination;
- Check all connection points on the lanyard for excessive wear (wear must not exceed 0.5 mm);
- Check that all shafts rotate freely;
- Check whether the teeth on the rope-gripper cam are severely worn;
- Check that the rope grab is in good working order;
- When the markings on the rope clamp are worn away and can no longer be read;

If any of the above inspection results indicate a problem—such as deformation or the inability of the shaft to rotate freely—the equipment must undergo appropriate maintenance, be scrapped, or be sent to the manufacturer for further inspection.

You should dispose of your product under the following circumstances:

- If the product's usage history is unclear;
- If you have concerns about the product's performance, strength, or safety;
- If the product fails a PPE inspection;
- If the product is malfunctioning;
- When the product fails to meet updated regulations or standards;
- After the product has been subjected to a high-load impact or a severe fall.

How to dispose of your equipment:

Mark the product with a permanent, non-removable label or physically destroy it to render it unusable (e.g., by drilling holes or cutting it); or return it to the manufacturer for disposal.

RESPONSIBILITY

·You are responsible for your own actions and decisions. If you cannot accept responsibility for the consequences, do not use this product.

· This product may only be used by qualified personnel, or under the direct visual supervision of qualified personnel who can accept responsibility.

· Users must undergo training prior to using this product. Training must include both theoretical and practical components. Users must understand the principles of working at heights, how to operate the equipment, and relevant knowledge of safety systems, and may only use the product independently after completing practical training.

· When the product is resold to other countries or regions, an instruction manual in the language used in that country must be provided.

· Xinda assumes no liability for any direct or indirect consequences resulting from the use of this product, unless caused by a quality defect.

MAINTENANCE

Proper maintenance and storage extend the equipment's service life and ensure user safety.

- Cleaning: Clean the surface and moving parts of the lift with clean water (20°C) and a soft-bristled brush. Do not use high-pressure water to clean the equipment, and do not use any industrial cleaning agents.

- After cleaning, rinse the equipment with clean water and allow it to air dry naturally. Do not expose the equipment to heat sources for drying.

Warning: Any unauthorized modification, replacement of parts, or repair of the product is strictly prohibited.

3-YEAR WARRANTY

We offer a 3-year warranty for defects in materials or workmanship. The warranty does not cover: wear and tear, deformation, oxidation, damage resulting from unauthorized modifications or repairs, improper operation, improper maintenance or storage, or damage caused by using the product for purposes other than those for which it was designed.