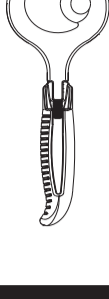



FIGURE 9 DESCENDER

9 字 环 下 降 器



Safety precautions

This manual explains how to use the equipment and only appropriate techniques and uses are described. Warning signs tell the potential risks but they don't cover everything. Please read every each warning carefully and use your equipment properly. Any misuse might lead to danger. If you are in doubt, please contact us.

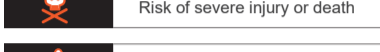

Risk of severe injury or death



Risk of accident or harm



Appropriate way of use



Incorrect way of use

Applicable rope diameter



$8 \leq \varnothing \leq 12\text{mm}$

Rope Inspection

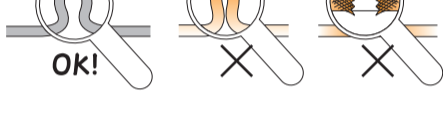

Style

a. Foldable-handle figure-9 descender

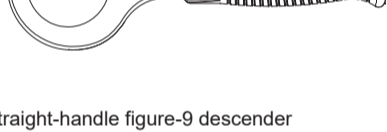

b. Straight-handle figure-9 descender

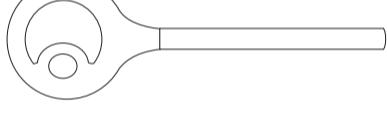

Part Name

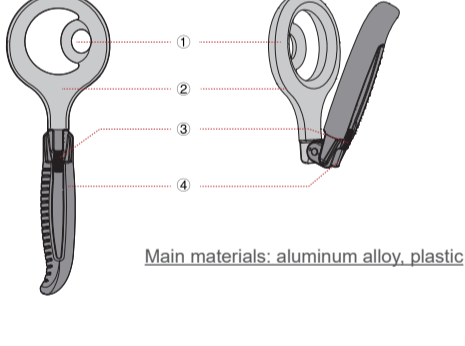

Main materials: aluminum alloy, plastic

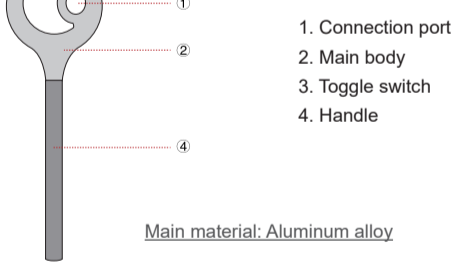

Main material: Aluminum alloy

Legend

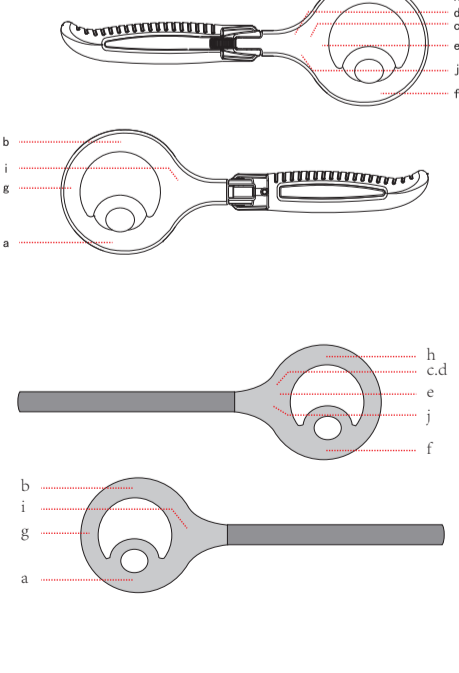

- a. Instructions on where to use the main lock
- b. A reminder to read the instructions before using the product
- c. Applicable standards
- d. EU CE certification mark
- e. Compatible rope diameter
- f. Country of origin
- g. Name of the manufacturer or brand name
- h. Unique product code
- i. Instructions for use
- j. Maximum working load

Installation and Use

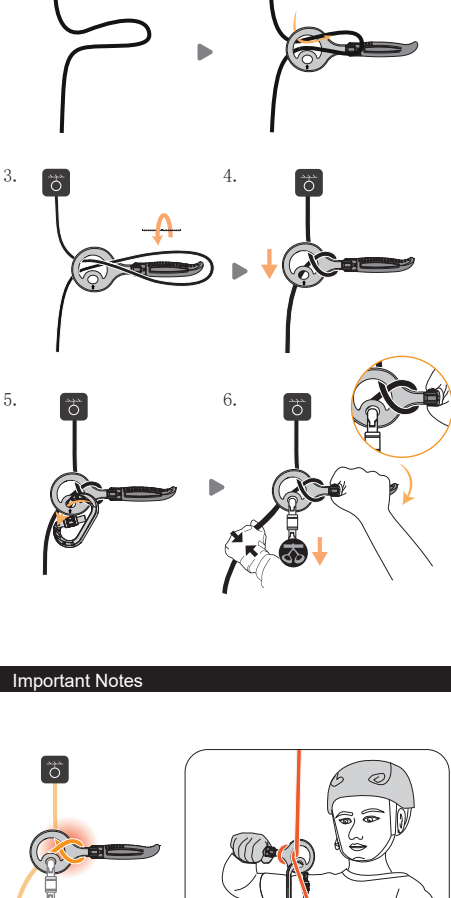

Important Notes

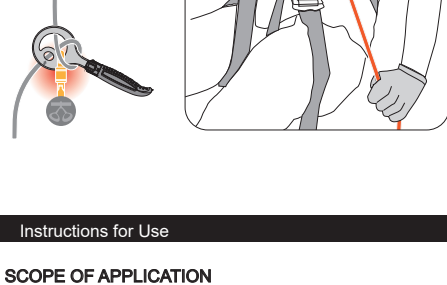

Instructions for Use

SCOPE OF APPLICATION

A descender with a braking assist function, designed as personal protective equipment (PPE) for fall protection during rope descent in climbing, rappelling, and engineering work environments.

When using this product, do not exceed its load limit, and do not use it for purposes other than those for which it was designed.

DISCLAIMER

WARNING

Any activity involving the use of this equipment carries inherent risks. You are responsible for your own actions, decisions, and safety.

Before using this equipment, you must:

- Read and understand the entire user manual.
- Undergo specific training on its proper use.
- Familiarize yourself with your equipment and understand its performance and limitations.

- Understand and accept the risks involved.

Failure to heed any of the above warnings may result in serious injury or death.

This product must be used by a competent and responsible person, or under the direct visual supervision of a competent and responsible person.

You are responsible for your own actions, decisions, and safety, and must accept the consequences. If you are unable to assume this responsibility or do not fully understand these instructions, do not use this equipment.

KEY INSPECTION POINTS

We recommend a thorough inspection at least once every 12 months.

Before each use:

Inspect the equipment's connection points and handles for cracks, deformation, corrosion, or excessive wear.

Note: Inspect the rope. Do not use the rope if it has been subjected to a fall, if the core is exposed or the structure has changed, or if the outer sheath is severely worn.

Before each use:

Ensure the carabiner is loaded in the direction of the main axis, and verify that the rope remains taut at all times with no foreign objects present.

COMPATIBILITY

Verify the product's compatibility with other components during operation (compatibility ensures proper functional interaction).

Compatible ropes: 8–12 mm. Note: Ropes with smaller diameters will result in weaker descent performance.

Maximum working load: 150 kg.

Rope Installation: Fold the rope as shown in the illustration (Fig. 4), thread it through the large ring, then rotate the rope inward by half a turn, feed it through the end of the handle, and tighten the rope. Check the direction of the rope's tension, and connect the spare carabiner to the 9-shaped ring via the connection hole.

Note: Use a carabiner with a locking mechanism to connect to the descender. After installation, perform a functional test to ensure the device is oriented in the direction of descent.

Descent: Hold the brake end of the rope with your left hand and press the handle downward with your right hand to descend. Adjust the descent speed by coordinating both hands; it is recommended to wear gloves to prevent the rope from injuring your hands.

Warning: High-speed descent can lead to loss of control, falls, and result in injury or even death.

Braking: The descender features an auxiliary braking function that automatically engages when both hands are released. However, in certain conditions (such as low-diameter ropes, ice, snow, or wet conditions), squeezing the rope may not fully stop the descent. When positioning for work, tie a braking knot to prevent the descender from slipping. This also prevents accidental compression of the handle by external objects, which could cause the braking mechanism to fail. Warning: If the rope is contaminated with oil, mud, or other substances, the device may become uncontrollable during use, resulting in personal injury or even death.

Other Uses: When attaching the descender to an anchor point for lowering, pay attention to the direction of the rope at the braking end to increase auxiliary friction.

ADDITIONAL SAFETY INFORMATION

●Users must be physically fit for work at heights. Unintentional suspension at heights can result in serious injury or even death within a short period of time.

●In industrial work environments, when a ascender is used in a personal rope access system, it must be used in conjunction with a fall arrest system. During operation, sufficient clearance must be maintained below the fall arrest system to prevent contact with obstacles or the ground in the event of a fall arrest.

●In industrial settings, individual anchor points must have a minimum breaking load of at least 12 kN or comply with the EN 795 standard.

●In a safety system, the system's strength is determined by its weakest link. Take care to prevent ropes or other webbing equipment from rubbing against sharp edges or rough surfaces. Conduct a risk assessment of the work environment before beginning work, and implement appropriate safety measures.

●Do not work alone. Before starting work, you must prepare an emergency response plan to ensure a swift rescue in the event of an accident.

RESPONSIBILITY

- You are responsible for your own actions and decisions. If you cannot accept responsibility for the consequences, do not use this product.

- This product may only be used by qualified personnel, or under the direct visual supervision of qualified personnel who can assume responsibility.

- Users must undergo training before using this product. The training includes both theoretical and practical components. Users must understand the principles of working at heights, how to operate the equipment, and the relevant safety systems, and may only use the equipment independently after completing the practical training.

- When a product is resold to other countries or regions, an instruction manual in the language used in that country must be provided.

- Unless caused by a quality issue, we assume no liability for any direct or indirect consequences resulting from the use of this product.

SERVICE LIFE, PERIODIC INSPECTIONS, AND EQUIPMENT RETIREMENT:

●Metal equipment stored under proper conditions has no storage time limit. If the metal product contains other plastic components, the storage life of the plastic components is 10 years, and that of the rubber components is 3 years.

●Due to improper operation, accidents, or compatibility issues between components, the product may be damaged as early as the first use.

●The actual service life of the product depends on the operating environment, frequency of use, and the severity of environmental conditions (such as marine environments, extreme temperatures, and sandy or muddy conditions). Whether the product has reached the end of its service life depends on regular inspections. In addition to inspecting the equipment before, during, and after each use, a comprehensive inspection must be conducted at least once every 12 months. If the equipment is used frequently, the inspection frequency should be increased. The results of these inspections must be recorded in the equipment inspection log.

YOU SHOULD DISPOSE OF YOUR PRODUCT WHEN ANY OF THE FOLLOWING SITUATIONS OCCUR:

- When connection points or handles are excessively worn;

- When the device's usage history is unknown;

- When you have concerns about the product's performance, strength, or safety;

- When the product fails a PPE inspection;

- When the product's functionality is compromised;

- When the product fails to meet updated regulations or standards;

- After the product has been subjected to a high-load impact or a severe fall;

How to scrap your equipment:

Mark the product with a permanent label or render it unusable through deliberate damage, such as drilling holes or cutting it; or return it to the manufacturer for disposal.

3-YEAR WARRANTY

Defects in materials or workmanship. The warranty does not cover: normal wear and tear, oxidation, unauthorized modifications or alterations, improper storage, poor maintenance, negligent use, or use for purposes other than those for which the product was designed.