



FIGURE OF EIGHT DESCENDER

八字环使用说明书



Safety Precautions

This manual explains how to use your equipment correctly. It describes only proven techniques and methods of use. Warning labels inform you of potential hazards associated with using this equipment, but they are not exhaustive. It is your responsibility to read every warning and use your equipment correctly. Any misuse will result in additional hazards. If you have any questions or difficulty understanding these documents, please contact us.

Installation Instructions

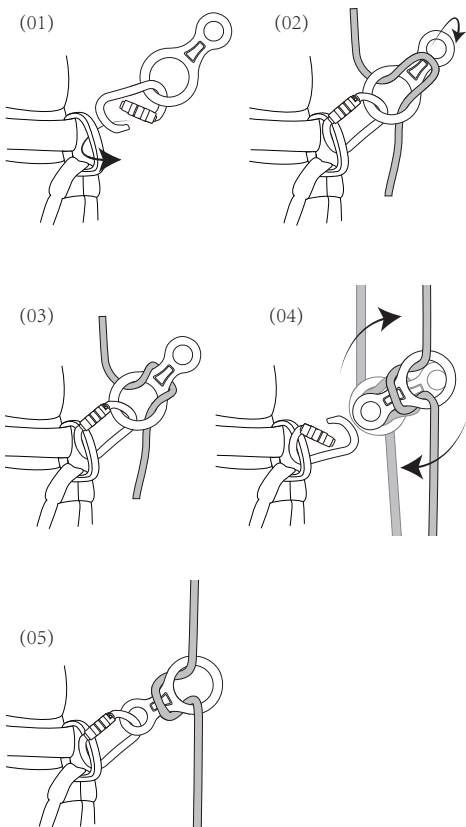

INTENDED USE

This product is intended for use as a safety and descent device in mountaineering, rock climbing, and similar activities.

Do not exceed the load limits of this product, and do not use it for purposes other than those for which it was designed.

LIABILITY

WARNING

All activities involving the use of this equipment carry inherent risks.

You are responsible for your own actions, decisions, and safety.

Before using this equipment, you must:

- Read and understand the entire user manual;
- Undergo specific training for the use of this equipment;
- Familiarize yourself with your equipment, understand its performance and usage limitations;
- Understand and accept the risks involved.

Failure to heed any of the above warnings may result in serious injury or death.

This product must only be used by competent and responsible individuals, or under the direct visual supervision of competent and responsible individuals.

You are responsible for your own actions, decisions, and safety, and must accept the consequences. Do not use this equipment if you are unable to assume this responsibility or do not fully understand these instructions.

INSPECTION AND CHECKING GUIDELINES

We recommend a thorough inspection at least once every 12 months.

Before Each Use

- Check the product for signs of breakage, deformation, scratches, excessive wear, corrosion, etc. Be aware of sharp edges that may develop with repeated use.

Before Each Use

- Ensure all components of the system are correctly connected to one another.
- Ensure there are no foreign objects in the rope groove.
- Ensure the carabiner connecting to the harness is always loaded in the direction of the main axis and is locked.
- Danger Warning: The carabiner (stop bar) must be correctly positioned and must move freely.

INSTALLATION

1. As shown in Figure (01), first connect the descender to the safety harness;
2. Thread the rope through the large ring, then loop it through the small ring;
3. Open the carabiner connecting the descender to the safety harness, remove the descender, and flip it so that the carabiner connects to the descender's small ring; (Always use a safety carabiner with a locking mechanism.)

Note: Check the compatibility of the carabiner and other equipment with the fall arrest device, and ensure they are suitable for rock climbing, mountaineering, caving, and work at height, and comply with the relevant European directives and standards. The fall arrest tube is equipped with a metal coil to prevent the tube from accidentally sliding along the rope. When not in use, it can also be used to hang the protection tube on your harness's gear loop. Never use this loop for belaying or rappelling operations.

Warning! Braking efficiency may be reduced when using thin ropes and/or new ropes and/or very smooth ropes. Please test the effectiveness of the described operation in a safe location where there is no risk of a fall. During rappelling (especially in areas with objective hazards, such as overhangs or areas with a risk of falling rocks), we recommend using a Prusik (self-locking knot). Ensure that the Prusik knot does not come into contact with the belay device when under load.

NOTE

Always tie a knot at the end of the rope to prevent accidental slippage.

Descent speed must be controlled to prevent the anchor device from overheating, which can lead to rapid wear on the descender itself and the rope.

SERVICE LIFE, PERIODIC INSPECTIONS, AND EQUIPMENT DISPOSAL

- Metal equipment stored in good conditions has no storage time limit. If the metal product contains plastic components, the storage life of these plastic components is 10 years.

- Due to improper operation, accidents, or compatibility issues between components, the product may be damaged during its very first use.

- The actual service life of the product depends on the environment in which the equipment is used, the frequency of use, and the severity of environmental conditions (e.g., marine environments, extreme temperatures, sandy environments, etc.). Determining whether a product has reached the end of its service life requires regular inspections. In addition to inspections before, during, and after each use, a comprehensive inspection must be conducted at least once every 12 months. If the equipment is used frequently, the inspection frequency should be increased.

- Inspections must be performed by personnel authorized by the manufacturer who are qualified to inspect PPE.

- A comprehensive inspection of the rope gripper includes:

· Checking the metal and plastic components of the rope gripper for corrosion, melting, cracks, excessive wear, deformation, or contamination;

· Checking all connection points of the rope gripper for excessive wear (wear must not exceed 0.5 mm);

· Checking whether all shafts rotate freely;

· Checking whether the teeth on the rope gripper's cam are severely worn;

· Checking whether the rope gripper functions properly;

· When markings on the rope gripper are worn and illegible;

If any of the above inspection criteria are met—such as deformation or pivots that do not rotate freely—the equipment must undergo appropriate maintenance, be retired, or be sent to the manufacturer for further inspection.

YOU MUST RETIRE YOUR PRODUCT UNDER THE FOLLOWING CIRCUMSTANCES:

· If the equipment's usage history is unclear;

· If you have doubts about the product's performance, strength, or safety;

· If it fails a PPE inspection;

· The product exhibits functional issues;

· The product fails to meet updated regulations or standards;

· The product has been subjected to a high-load impact or a severe fall.

HOW TO DISPOSE OF YOUR EQUIPMENT:

Mark the product with a permanent, non-removable label or physically destroy it to render it unusable (e.g., drilling holes or cutting it); or return it to the manufacturer for disposal.

LIABILITY

· You are responsible for your own actions and decisions. If you cannot accept responsibility for the consequences, do not use this product.

· This product may only be used by qualified personnel, or under the direct visual supervision of qualified personnel who can assume responsibility.

· Training is required before using this product. Training must include both theoretical and practical components. Users must understand the principles of working at heights, how to use the equipment, and knowledge of safety systems, and may only use the product independently after completing practical training.

· When the product is resold to other countries or regions, an instruction manual in the language used in that country must be provided.

· Unless due to a quality defect, Xinda assumes no liability for any direct or indirect consequences resulting from the use of this product.

Warning: Any unauthorized modification, replacement of parts, or repair of the product is strictly prohibited.

3-YEAR WARRANTY

We provide a 3-year warranty against defects in materials or workmanship. The warranty does not cover: wear and tear, deformation, oxidation, unauthorized modifications or repairs, improper operation, improper maintenance or storage, or damage resulting from use for purposes other than those for which the product was designed.